







Σ
IGMA

IGMA







Bed room
10'0" X 11'2"

Duct

16

Living
12'8" X 14'10"

C. Toilet
6'5" X 4'6"

A. Toilet
6'5" X 4'6"

TRICKS

M. Bedroom
12'0" X 10'0"

Dining/Kitchen
16'0" X 8'0"

Balcony/Utility
15'10" X 4'0"

M. Bedroom
13'0" X 10'0"

Bedroom
11'6" X 10'0"

A. Toilet
4'6" X 8'8"

23

Living/Dining
26'2" X 11'0"

Balcony
10'10" X 4'0"

M. Bedroom
13'8" X 10'0"

4'6" X 5'0"

A. Toilet
4'6" X 8'8"

Toilet
4'6" X 8'8"

Kitchen
8'0" X 10'0"

Utility
10'0" X 4'0"

BRICKS™

DS-MAX SIGMA PHASE II Block - A



DS-MAX SIGMA PHASE II

Block - B



DS-MAX SIGMA PHASE II

Block - C

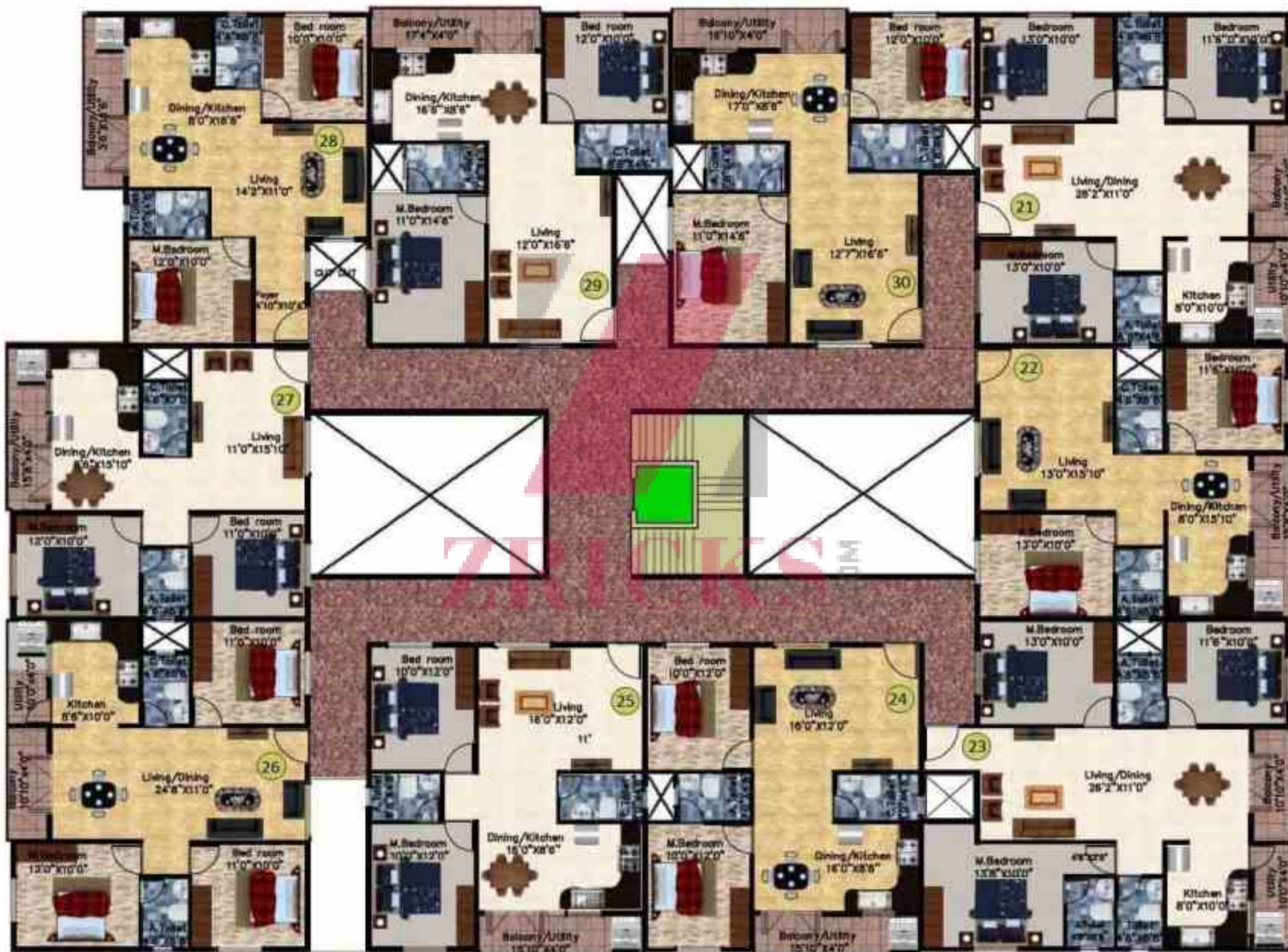

DS-MAX SIGMA PHASE II

Block - D



Route Map

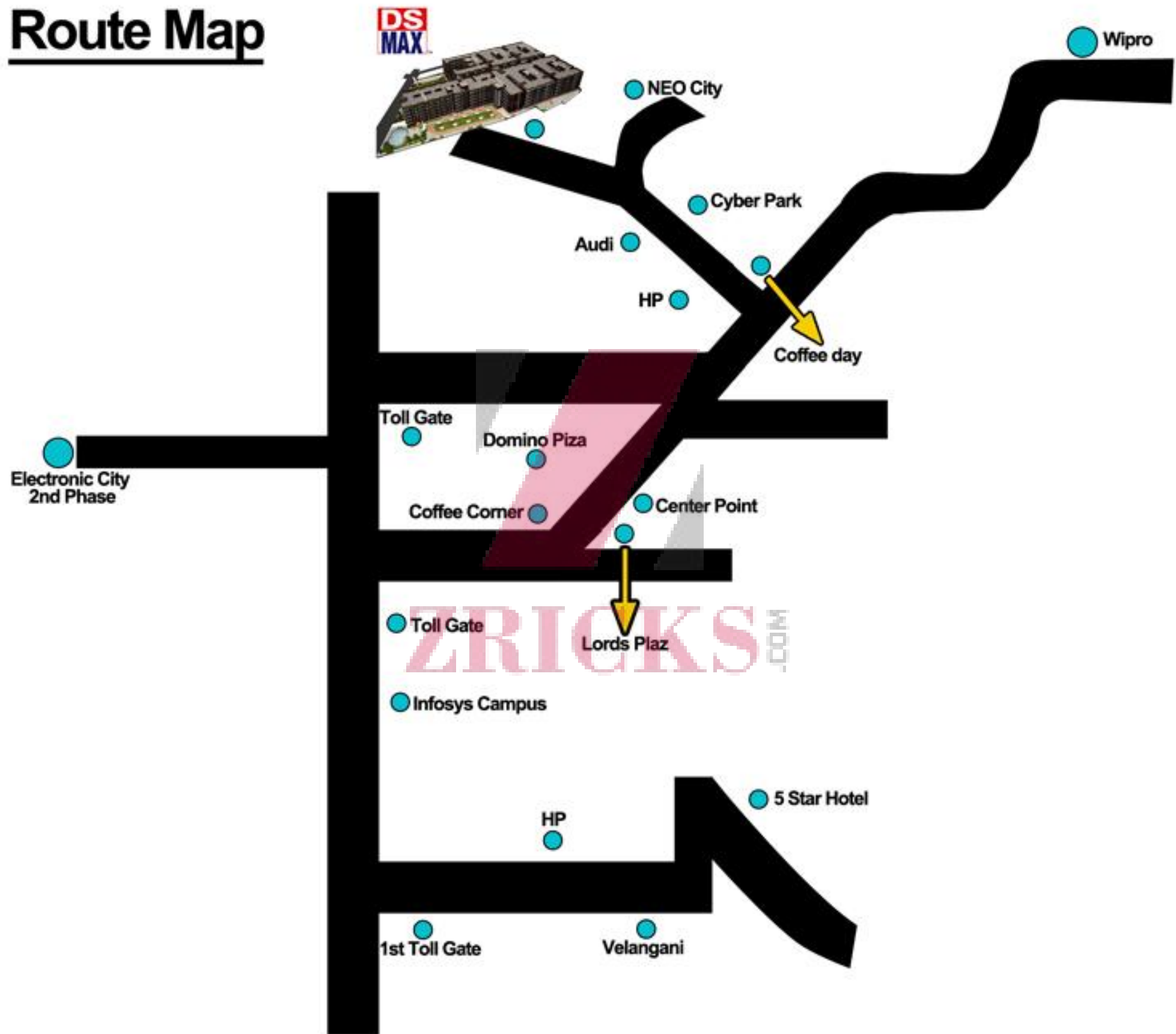



Specifications

Total No. Of Flats : Ground + 4 Floor - 2 & 3 BHK Luxurious Flats

Location : Electronic City

Built-up area : Ground + 4 Floors

F1 - 1470Sqft, F2- 1150Sqft, F3- 1150Sqft, F4- 1170Sqft, F5- 1450Sqft, F6 - 1450Sqft, F7- 1130Sqft, F8- 1180Sqft, F9 - 1180Sqft, F10 - 1410Sqft, F11 - 1510Sqft, F12 - 1160Sqft, F13 - 1190Sqft, F14 - 1165Sqft, F15 - 1165Sqft, F16 - 1100Sqft, F17 - 1630Sqft, F18 - 1160Sqft, F19 - 1160Sqft, F20 - 1410Sqft, F21 - 1530Sqft, F22 - 1210Sqft, F23 - 1600Sqft, F24 - 1220Sqft, F25 - 1240Sqft, F26 - 1425Sqft, F27 - 1145Sqft, F28 - 1160Sqft, F29 - 1330Sqft, F30 - 1320Sqft, F31 - 1470Sqft, F32 - 1165Sqft, F33 - 1600Sqft, F34 - 1220Sqft, F35 - 1255Sqft, F36 - 1400Sqft, F37 - 1140Sqft, F38 - 1425Sqft, F39 - 1280Sqft, F40 - 1310Sqft.

Structure : RCC Framed Structure

Walls : Concrete Block Construction

Flooring : Vitrified flooring throughout the flats

Doors : Main door of natural wood frame. Shutters with both side Masonite skin

Electrical : Anchor/equivalent Modular Switches, Anchor/equivalent Copper wires

Windows : Powder coated anodized aluminium windows

Kitchen : Black Granite platform slab with stainless steel sink

Painting : Oil Bound Distemper

Plumbing : European Water Closet (EWC) of branded make, hot & cold water mixer unit with shower in all toilets, all chromium plated fittings of branded make